

## LIQUID COOLED HIGH FREQUENCY SPINDLE WITH ID PILOT – TYPE HF/IDP

ALL CRITICAL PARTS ARE HARDENED AND GROUND.  
ALL SPINDLES ARE BALANCED.

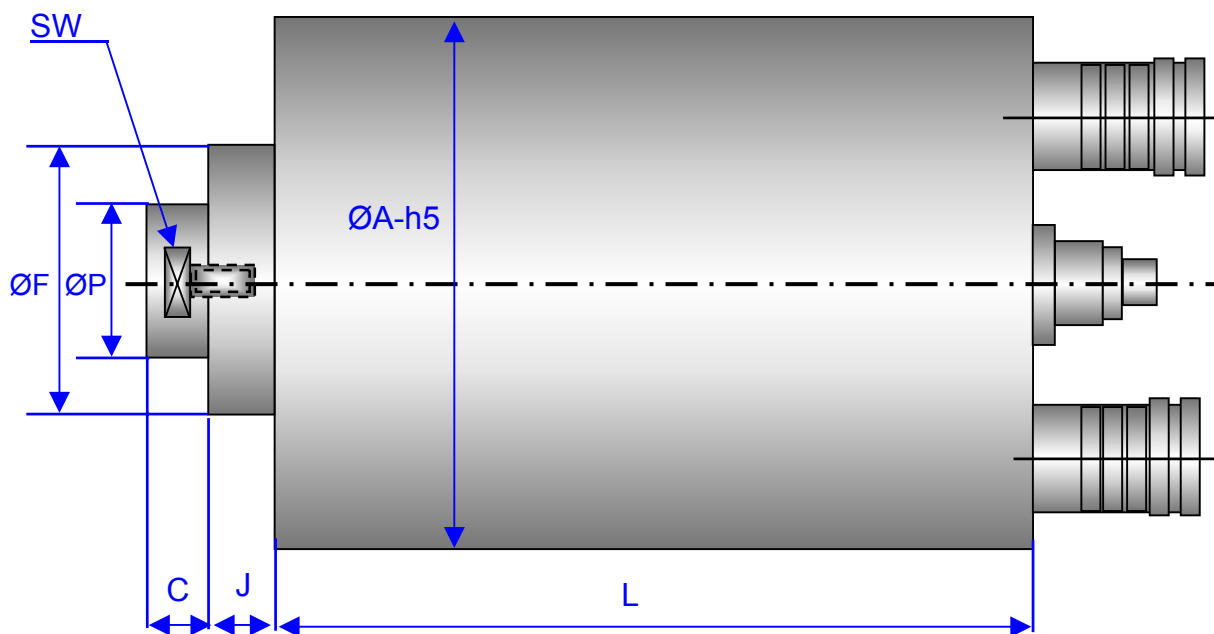

CEN Type	A	F	P	L	C	J	SW	RPM	KW 100%
CEN HF80X200/120000/IDP5	80	40	16	200	8	6	12	120,000	0.4
CEN HF80X200/90000/IDP7	80	40	18	200	8	6	17	90,000	0.65
CEN HF80X200/75000/IDP8	80	50	23	200	11	12	22	75,000	0.5
CEN HF80X200/60000/IDP10	80	50	26	200	11	17	24	60,000	2
CEN HF80X230/60000/IDP10	80	50	26	230	11	17	24	60,000	2.5
CEN HF80X200/45000/IDP14	80	50	32	200	13	22	30	45,000	2
CEN HF80X200/30000/IDP16	80	50	32	200	13	22	30	30,000	1.65
CEN HF80X200/24000/IDP16	80	50	32	200	13	22	30	24,000	1.3
CEN HF120X193/75000/IDP7	120	79	18	193	9	38	15.875(5/8)	75,000	6

- ❖ ALL DIMENSIONS IN <MM>
- ❖ GREASE LUBRICATED
- ❖ LIQUID COOLED – STRAIGHT QUILL

[www.centerline-inc.com](http://www.centerline-inc.com)